

Section Key

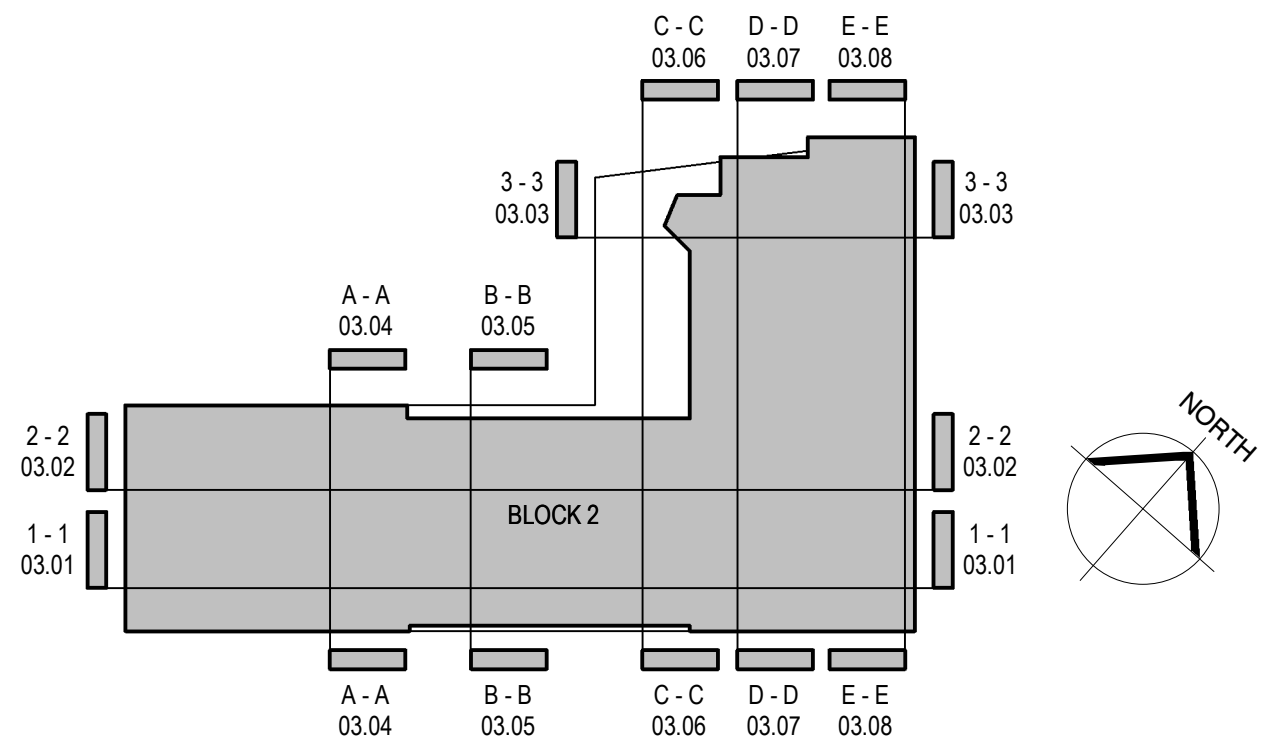

C04	23/07/20	Revised Planning Drawings - Reduced heights Block 1 and Block 2 and minor elevation amendments	JS/RB
C03	11.05.20	Updated for Revised Planning Application	JS/MP
P5	04.05.20	Draft Issue	JS/MP
C02	15.10.19	Amendment to Planning Drawing	MP/MP
C01	15.10.19	Planning Issue	JS / MP
P4	27.09.19	DRAFT PLANNING APPLICATION ISSUE	PA / MP
P3	19.09.19	ISSUED FOR CO-ORDINATION	PA / MP
P2	11.07.19	DRAFT ISSUE FOR INFORMATION	PA / MP
P1	07.06.19	DRAFT ISSUE FOR CO-ORDINATION	PA / MP
REV	DATE	COMMENT	AUTH/CHKD

PROJECT TITLE		
Harlequins Block 2		
DETAIL		
B2 Section 3 - 3		
DRAWING NUMBER (PROJECT-ORIGINATOR-ZONE-LEVEL-TYPE-ROLE-NUMBER)		
EHQ- LHC- 02 - ZZ - DR- A - 03.03		
STATUS		STATUS DESCRIPTION
S2		Planning Issue
REVISION	DATE	SCALE
C04	05/16/19	1 : 100@A1
CONTRACTORS MUST CHECK ALL DIMENSIONS ON SITE - ONLY FIGURED DIMENSIONS ARE TO BE WORKED FROM - DISCREPANCIES MUST BE REPORTED TO THE ARCHITECT BEFORE PROCEEDING & THIS DRAWING IS COPYRIGHT		LHC PROJECT NUMBER
		17161

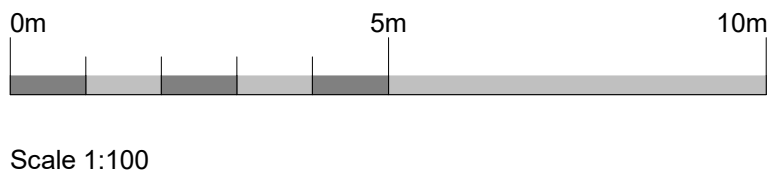

■ EXETER

01392 444334

□ PLYMOUTH

01752 669368

□ ST AUUSTELL

01892 955125

lhc.net