

Refer to Advanced Arboriculture Ltd. Tree Constraints Appraisal for details of Identified trees and tree groups in proximity of proposed development.

Dimensions are not to be scaled from this drawing. Drawing to be read in conjunction with Building regulation notes.

Rev	Date	Description	Author
C	03 Nov '21	Planning Issue.	ah

ANNOTATIONS

- 1a Proposed new Changing Pavilion & Classrooms. Schedule of Accommodation and Floor Plans of the proposed Flowerpot Fields Pavilion indicated on drawing PL05 - Proposed Floor Plans.
- 1b Existing Changing Rooms to be Demolished.
- 2 Existing car parking and landscaping to be retained and modified if required to reflect the access and layout of the proposed Pavilion.
- 3 Existing Flood Defence Bank retained.
- 4a Existing vehicular access route over flood defence bank retained.
- 4b Existing vehicular access route over flood defence bank omitted.
- 5 Existing Cricket Pitch retained unaltered.
- 6 Existing Rugby Pitch retained unaltered. Approx o/a size 126x75m.
- 7 Existing Rugby Pitch replaced.
- 8 Existing playing area.
- 9 Railway Line.
- 10 Skate Park.
- 11 Millers Crossing.
- 12 Existing Exeter College Sports Hub & All Weather Football Pitch.
- 13 Proposed location of the new all-weather, floodlit rugby pitch. Minimum recommended RFU size. o/a size: 116 x 80m. Playing Area: 106 x 68m. Perimeter: 5m (enlarged by 2m on dugout side)
- 14 Existing footpaths modified to suit new pitch.

- Site Boundary
- Other Land in Ownership of Applicant.

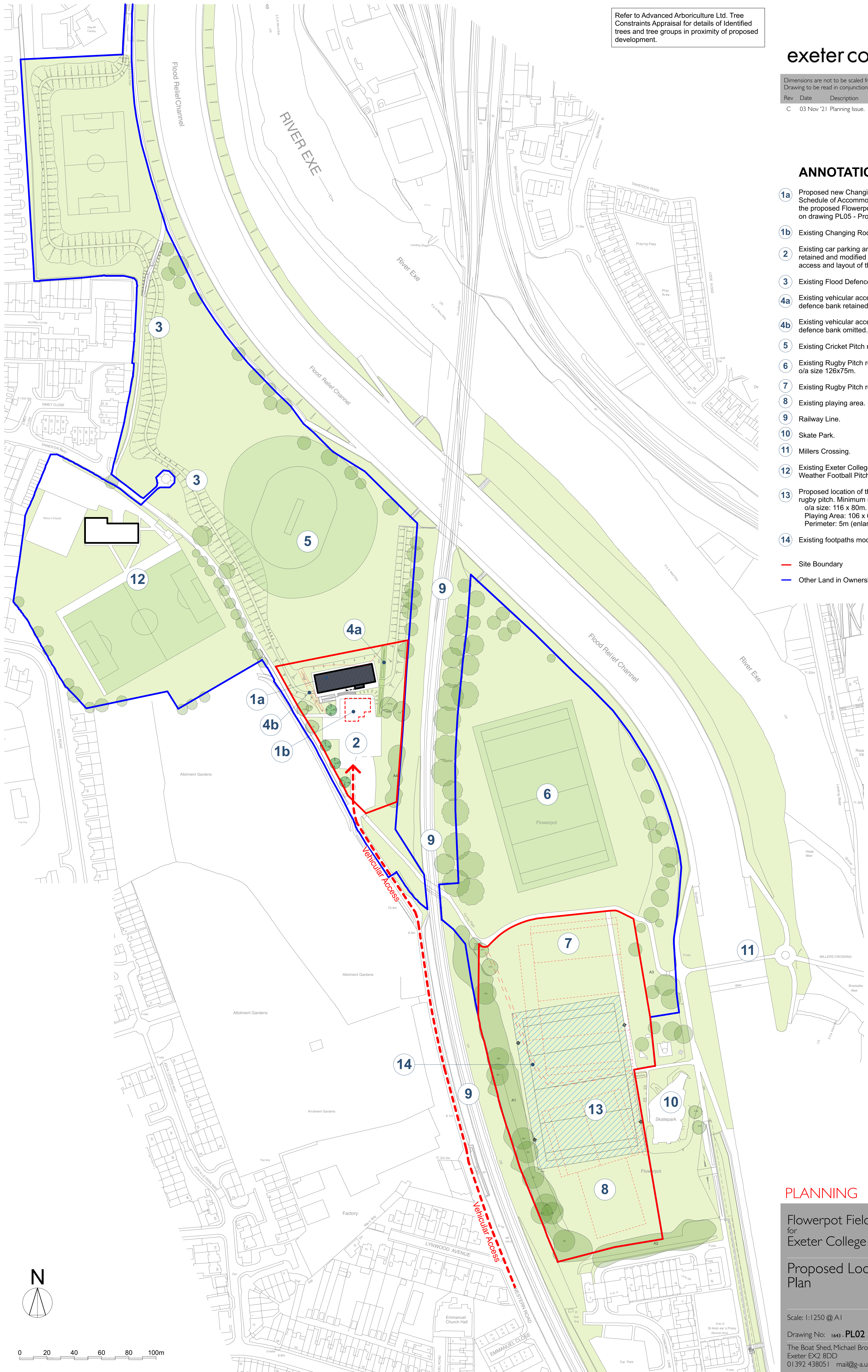

PLANNING

Flowerpot Fields Pavilion
for
Exeter College

Proposed Location
Plan

Scale: 1:1250 @ A1
Drawing No: 1643 - PL02 Rev C
The Boat Shed, Michael Browning Way
Exeter EX2 8DD
01392 438051 mail@g-a.uk.com