

Section Key

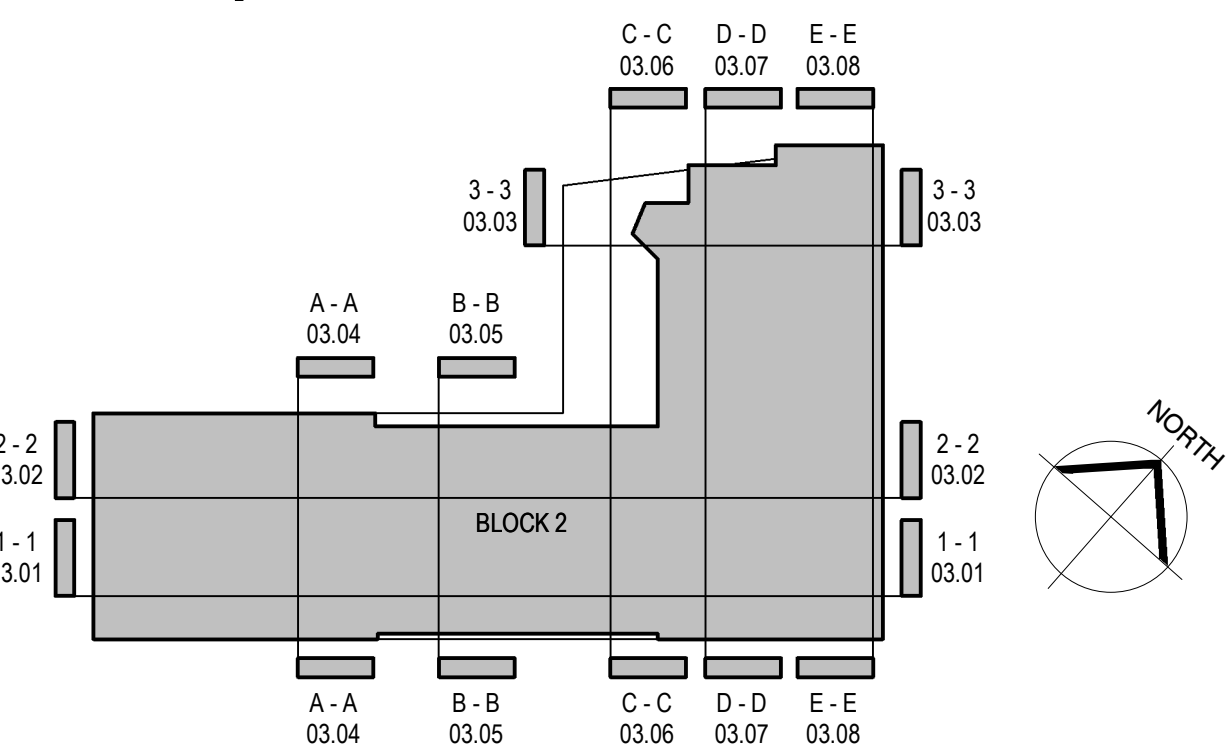

C02	15.10.19	Amendment to Planning Drawing Planning Issue DRAFT PLANNING APPLICATION ISSUE ISSUED FOR CO-ORDINATION DRAFT ISSUE FOR INFORMATION DRAFT ISSUE FOR CO-ORDINATION	MP/MP
C01	15.10.19		JS / MP
P04	27.09.19		PA / MP
P03	19.09.19		PA / MP
P02	11.07.19		PA / MP
P01	07.06.19		PA / MP
REV	DATE	COMMENT	AUTH/CHKD

PROJECT TITLE

Harlequins Block 2

DETAIL

G.A. Section 3 - 3

DRAWING NUMBER (PROJECT-ORIGINATOR-ZONE-LEVEL-TYPE-ROLE-NUMBER)

EHQ- LHC- 02 - ZZ - DR - A - 03.03

STATUS	STATUS DESCRIPTION
S2	Planning Issue

REVISION	DATE	SCALE
C02	05/16/19	1 : 100@A1

CONTRACTORS MUST CHECK ALL DIMENSIONS ON SITE - ONLY FIGURED DIMENSIONS ARE TO BE WORKED FROM - DISCREPANCIES MUST BE REPORTED TO THE ARCHITECT BEFORE PROCEEDING & THIS DRAWING IS COPYRIGHT

LHC PROJECT NUMBER
17161

lhc design

■ EXETER
01932 444334

☐ PLYMOUTH
01752 669368

☐ ST AUSTELL
01892 955125

lhc.net

