

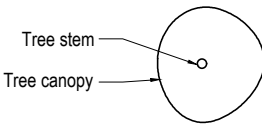
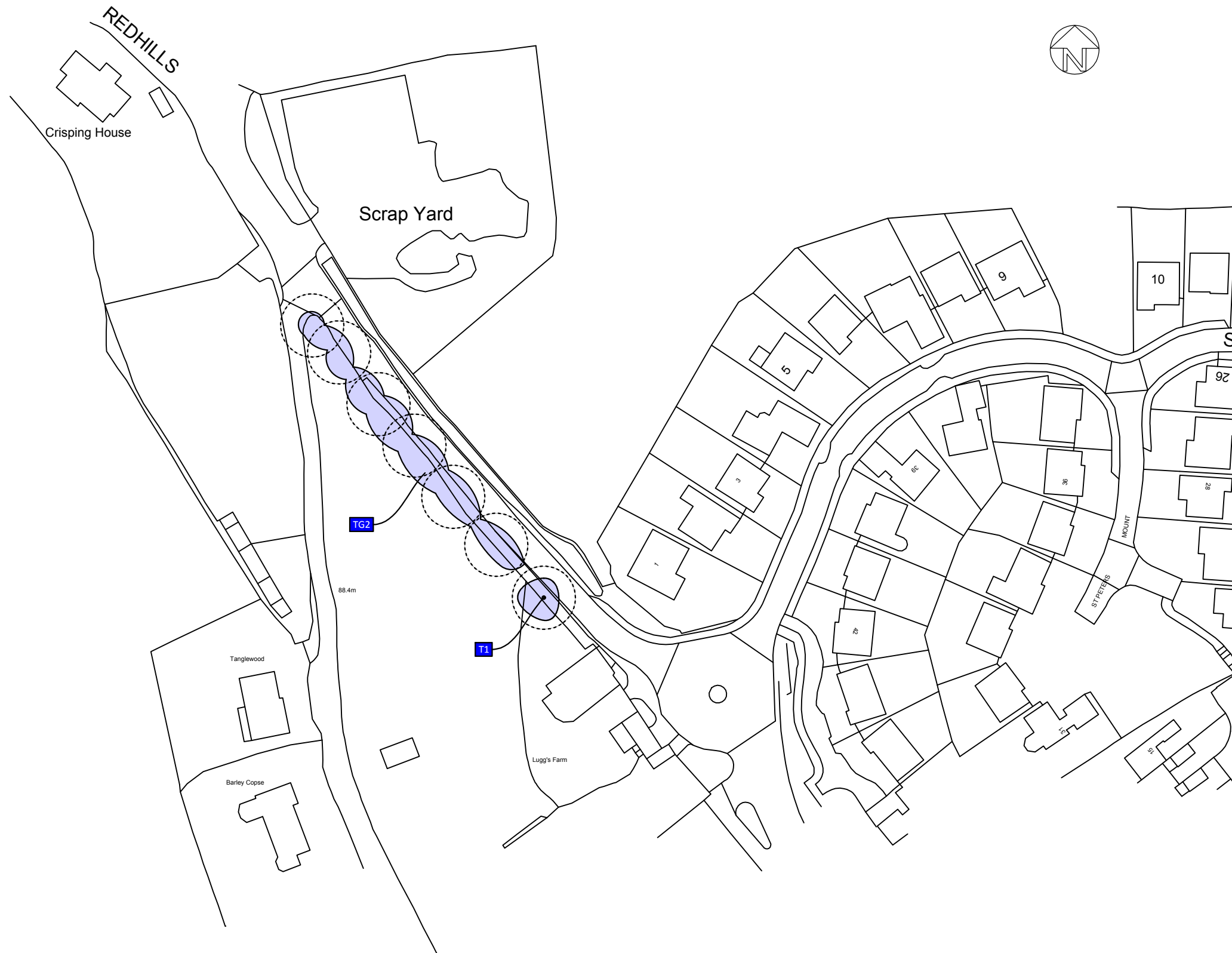

Tree Constraints - above ground 	Tree survey ref & BS5837 category		Root Protection Area	
	T01 'A' cat T02 'B' cat T03 'C' cat T04 'U' cat	 Default RPA BS5837:2012 Tx Individual Tree TGx Tree Group Hx Hedgerow Wx Woodland		



Tree Survey Data						
Ref	Species	Hgt (m)	Stem (mm)	Crown Hgt (m)	Age	BS cat
T1	Oak <i>Quercus robur</i>	14	600	5	EM	B1
T1 is located in the highway verge in an elevated position.						
TG2	Ash (95%) <i>Fraxinus excelsior</i> Sycamore <i>A. pseudoplatanus</i> Oak <i>Quercus robur</i>	15-17	200-300	5	SM EM M	B2
TG2 is a linear tree group of multi stemmed coppiced trees, which have grown out of the original hedgerow along the top of the highway verge banking. The hedge has suffered from a lack of management and is now dominated by Ash and Sycamore, with the understorey now largely defunct. These trees will require re-coppicing in the foreseeable future.						