

Scale 1:100

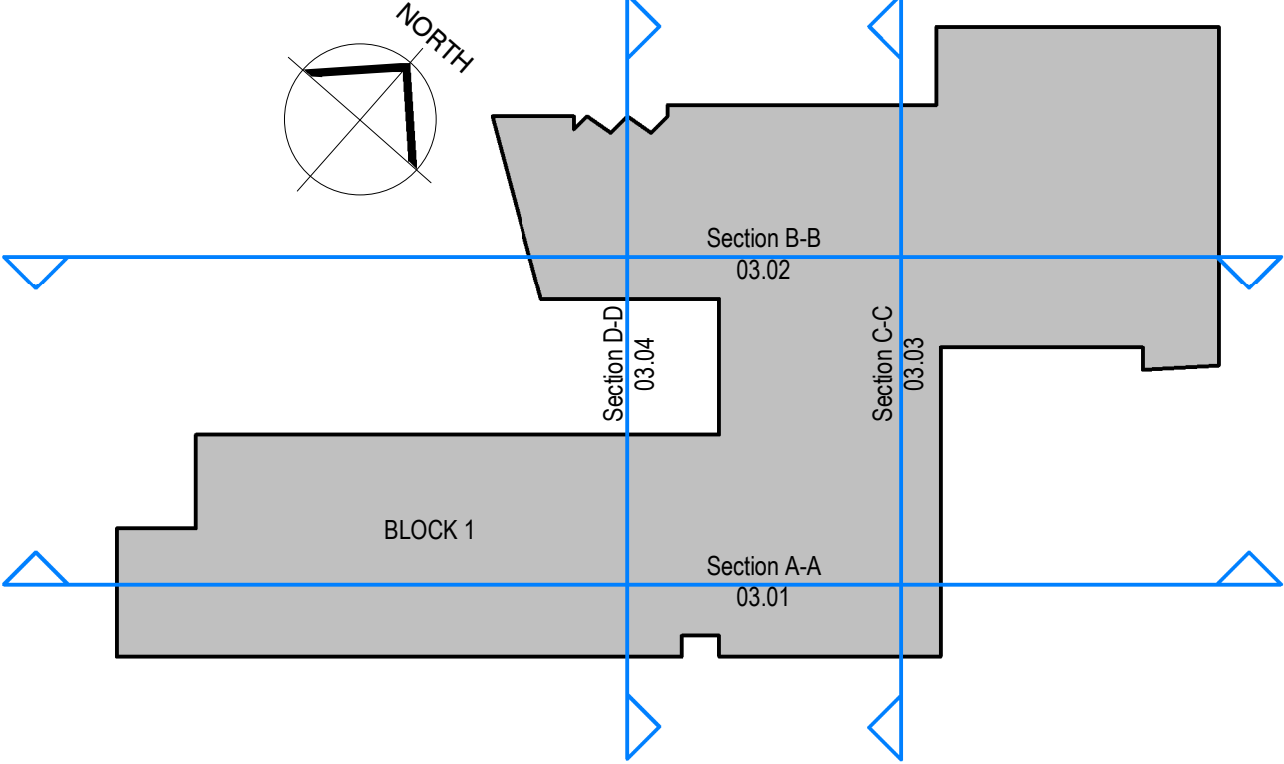

Section C-C  
1 : 100

Section Key



C01	10/10/19	Planning Issue	JS/MP
P03	27/09/19	Draft Planning Issue	JS/MP
P02	15/07/19	Issued for Co-ordination	JS/MP
P01	05/04/19	First Issue	JS/MP

REV	DATE	COMMENT	AUTH/CHKD

PROJECT TITLE  
Harlequins Block 1

DETAIL  
B1 Section C-C

DRAWING NUMBER (PROJECT-ORIGINATOR-ZONE-LEVEL-TYPE-ROLE-NUMBER)  
EHQ- LHC- 01 - ZZ - DR- A - 03.03

STATUS	STATUS DESCRIPTION	
S2	Planning Issue	

REVISION	DATE	SCALE
C01	03/28/19	1 : 100@A1

CONTRACTORS MUST CHECK ALL DIMENSIONS ON SITE - ONLY FIGURED DIMENSIONS ARE TO BE WORKED FROM - DISCREPANCIES MUST BE REPORTED TO THE ARCHITECT BEFORE PROCEEDING & THIS DRAWING IS COPYRIGHT

LHC PROJECT NUMBER  
17161

EXETER

01392 444334

PLYMOUTH

01752 669368

ST AUSTELL

01892 955120

lhc.net