

Scale 1:100

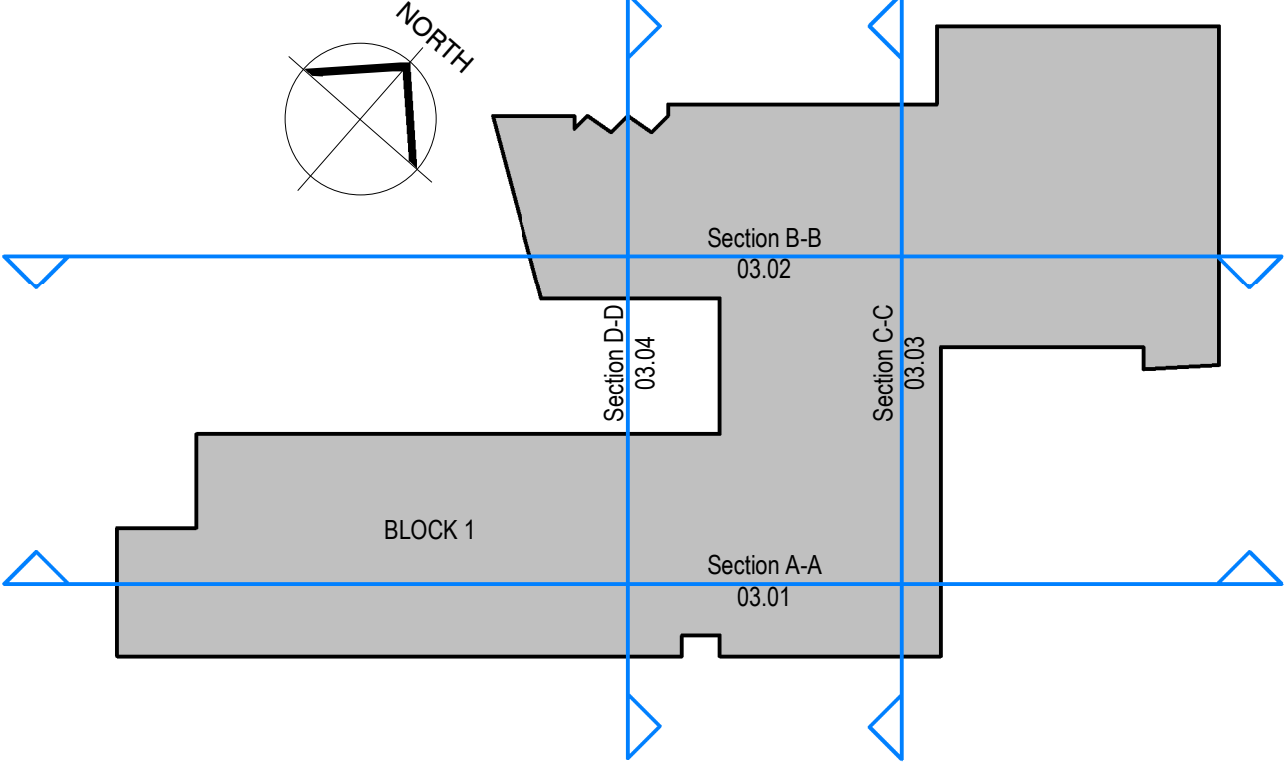

Section D-D
1 : 100

Section Key



| | | | |
|-----|----------|--|-----------|
| C03 | 23/07/20 | Revised Planning Drawings - Reduced heights Block 1 and Block 2 and minor elevation amendments | JS/RB |
| C02 | 11/05/20 | Updated for Revised Planning Application | JS/MP |
| P05 | 04/05/20 | Draft Issue | JS/MP |
| C01 | 10/10/19 | Planning Issue | JS/MP |
| P04 | 27/09/19 | Draft Planning Issue | JS/MP |
| P03 | 15/07/19 | Issued for Co-ordination | JS/MP |
| P02 | 07/06/19 | Draft Issue for Co-ordination | JS/MP |
| P01 | 05/04/19 | First Issue | JS/MP |
| REV | DATE | COMMENT | AUTH/CHKD |

| | | |
|---|----------|--------------------|
| PROJECT TITLE | | |
| Harlequins Block 1 | | |
| DETAIL | | |
| B1 Section D-D | | |
| DRAWING NUMBER (PROJECT-ORIGINATOR-ZONE-LEVEL-TYPE-ROLE-NUMBER) | | |
| EHQ- LHC- 01 - ZZ - DR- A - 03.04 | | |
| STATUS | | STATUS DESCRIPTION |
| S2 | | Planning Issue |
| REVISION | DATE | SCALE |
| C03 | 04/03/19 | 1 : 100@A1 |
| CONTRACTORS MUST CHECK ALL DIMENSIONS ON SITE - ONLY FIGURED DIMENSIONS ARE TO BE WORKED FROM - DISCREPANCIES MUST BE REPORTED TO THE ARCHITECT BEFORE PROCEEDING & THIS DRAWING IS COPYRIGHT | | LHC PROJECT NUMBER |
| | | 17161 |