



AEW Architects and Designers LTD
The Zenith Building
Spring Gardens
Manchester M2 5AB
t: +44 (0) 161 214 4370
f: +44 (0) 161 214 4371



Notes:
All drawings to be read in conjunction
with all other drawings as noted on
issue sheet.

Application boundary:

McDonald's demise indicated thus:

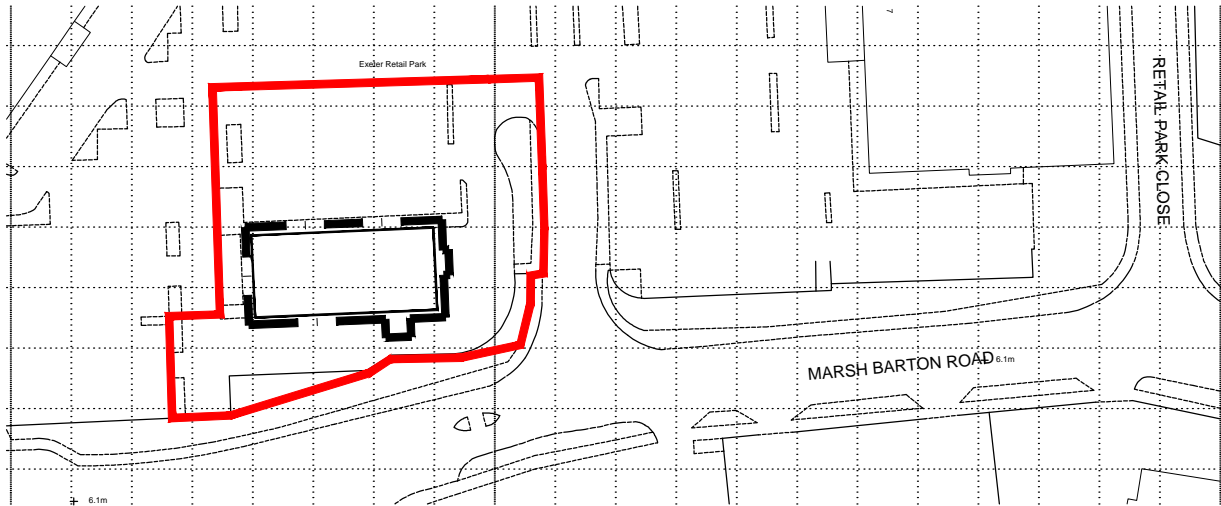

Ordnance Survey (c) Crown Copyright 2010. All rights reserved. Licence number 100020449

LOCATION PLAN

SCALE BAR

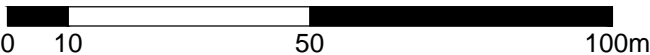

REV.	DATE	DRAWING REVISIONS	BY	CHECKED

GENERAL NOTES:
All works are to be undertaken in accordance with the Building
Regulations and the latest British Standards.
All proprietary materials and products are to be used strictly in
accordance with the manufacturers recommendations.
All dimensions to be checked on site prior to construction.

PROPOSED DEVELOPMENT AT	STONE No :-
Stone Lane Retail Park Marsh Barton Road, Exeter. EX2 8LH	0972

ON BEHALF OF :-
McDonald's Restaurants Ltd

DRAWING TITLE :-
LOCATION PLAN

DRAWN BY	CHECKED BY	DRAWING No.	REV. No.
AI	IRD	5262_0972_0001	-
SCALE & SIZE	DATE	19.03.13	
1:1250@A4			



AEW Architects and Designers LTD
The Zenith Building
Spring Gardens
Manchester M2 5AB
t: +44 (0) 161 214 4370
f: +44 (0) 161 214 4371



PLANNING