

The Statutor

Project details	
Planning authority:	
Project name:	
Applicant:	
Application type:	
Planning application reference:	
Completed by:	
Date of metric completion:	
Reviewer:	
Calculation iteration:	
Planning authority reviewer:	
Date of planning authority review:	
Target % net gain:	10%
Irreplaceable habitat present at baseline:	
Total site area - including irreplaceable habitat area (hectares):	0.33
Total off-site area - including irreplaceable habitat area (hectares):	N/A

Cell style conversion	
⚠	
▲	

On-site baseline map Insert

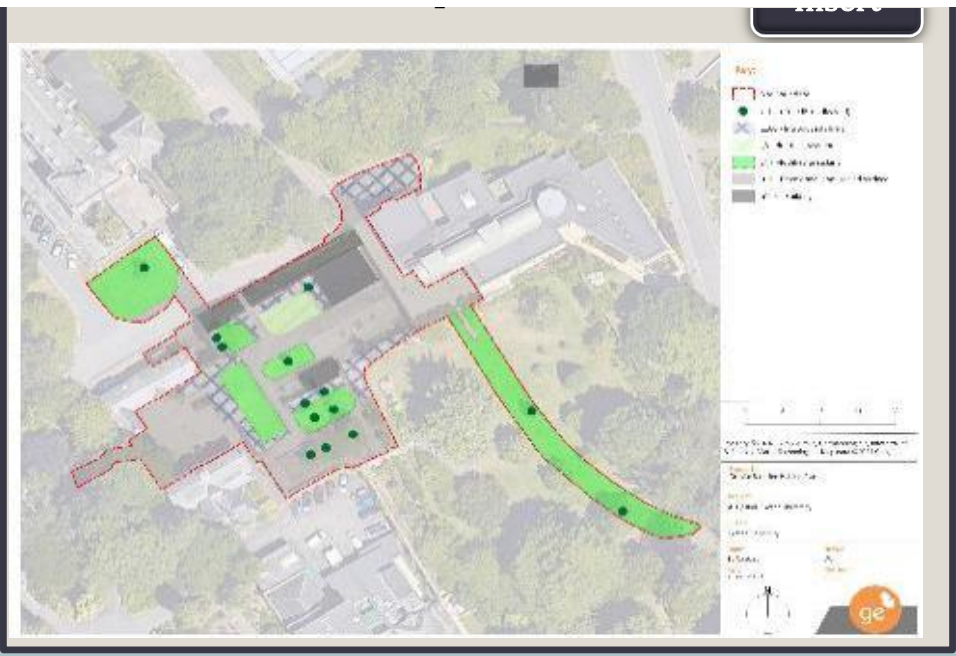

On-site baseline map reference number



Off-site baseline map reference number

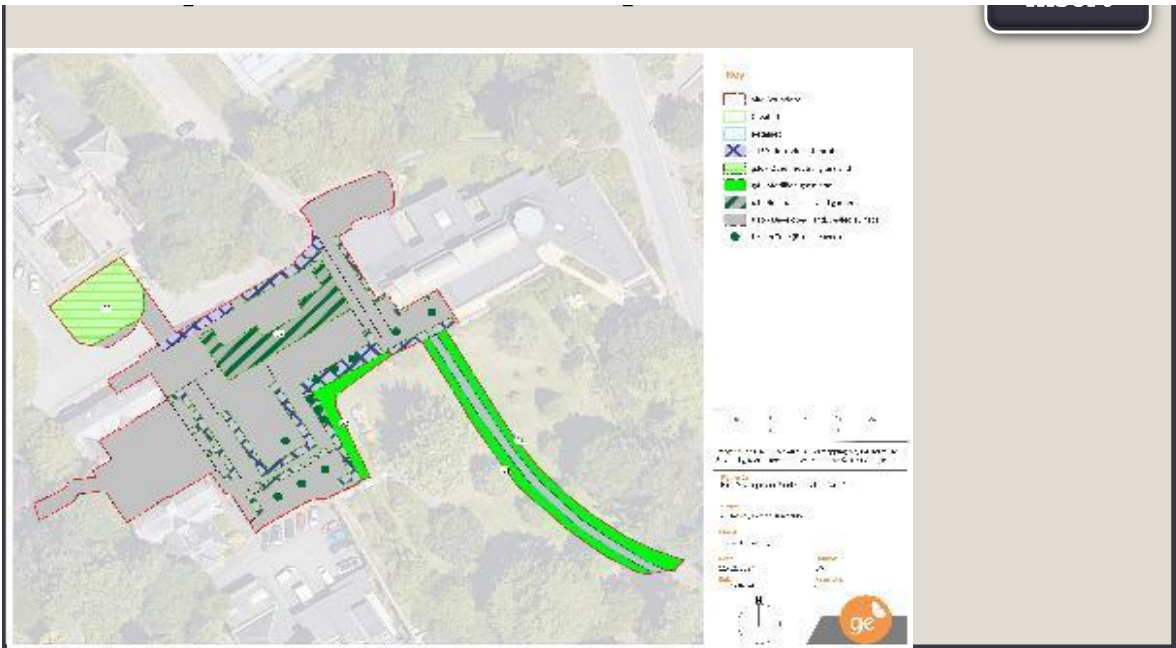

On-site post-intervention map reference number

Off-site post intervention map

Insert

Off-site post-intervention reference number





menu

ults

y all

view



Key

-  Area habitats
-  Hedgerows and lines of trees
-  Watercourses

The Statu

[Start page](#)

Start here

1



2



On-site baseline

- A-1 On-site Area Habitat Baseline**

- B-1 On-site Hedge Baseline**

- C-1 On-site Watercourse Baseline**

On-site post developo

- A-2 On-site Area Habitat Creation**

- A-3 O**
Enh
- B-2 On-site Hedge Creation**

- B-3 O**
Enh
- C-2 On-site Watercourse Creation**

- C-3 On-s**
En



Laboratory Biodiversity Metric

Main menu

Technical data

Results

3

Equipment

On-site Area
Habitat
enhancement



On-site Hedge
enhancement



On-site Watercourse
enhancement



Off-site baseline

D-1
Off-site
Area Habitat
Baseline



E-1
Off-site Hedge
Baseline



F-1
Off-site Watercourse
Baseline



D-1
H

E-2

Water



Tree helper						
Tree size	Number of trees and area (ha) for each condition state					
	Poor	Area	Moderate	Area	Good	Area
Small		0.0000		0.0000		0.0000
Medium		0.0000		0.0000		0.0000
Large		0.0000		0.0000		0.0000
Very large		0.0000		0.0000		0.0000
Total	0	0.0000	0	0.0000	0	0.0000

4

Off-site post development

D-2 Off-site Area
Habitat Creation



D-3 Off-site Area Habitat
Enhancement



E-2 Off-site Hedge
Creation



E-3 Off-site Hedge
Enhancement



F-2 Off-site
Watercourse Creation



F-3 Off-site Watercourse
Enhancement





The Statutor

[Return to start page](#)

[Headline results](#)

[De](#)

[Off-site summary](#)

[In hab](#)

ry Biodiversity Metric Results

tailed results

Habitat trading
summaries

rreplaceable
itats summary

Unit shortfall
summary

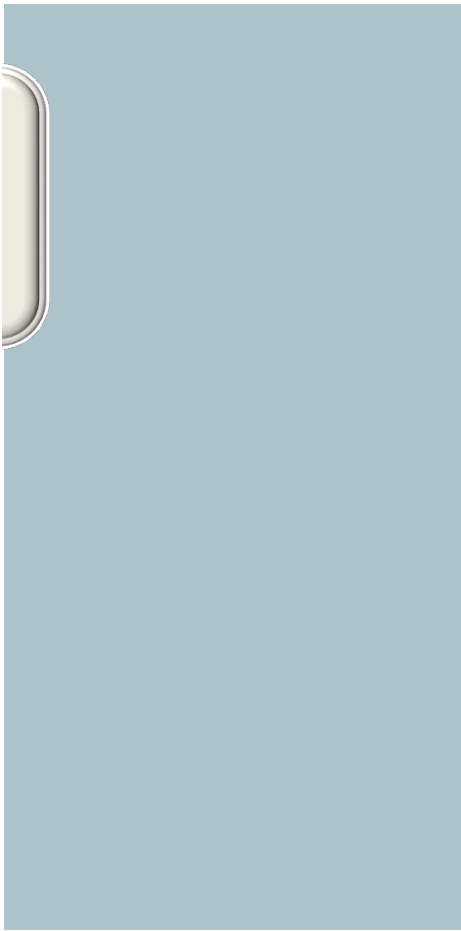

Al Qasimi Exeter University

Headline Results

Scroll down for final results ⚠

Return to
results menu

On-site baseline

Habitat units

Hedgerow units

Watercourse units

On-site post-intervention

(Including habitat retention, creation & enhancement)

Habitat units

Hedgerow units

Watercourse units

On-site net change

(units & percentage)

Habitat units

Hedgerow units

Watercourse units

Off-site baseline

Habitat units

Hedgerow units

Watercourse units

Off-site post-intervention

(Including habitat retention, creation & enhancement)

Habitat units

Hedgerow units

Watercourse units

Off-site net change

Habitat units

Off-site net change

(units & percentage)

Hedgerow units

Watercourse units

Combined net unit change

(Including all on-site & off-site habitat retention, creation & enhancement)

Habitat units

Hedgerow units

Watercourse units

Spatial risk multiplier (SRM) deductions

Habitat units

Hedgerow units

Watercourse units

FINAL RESULTS

Total net unit change

(Including all on-site & off-site habitat retention, creation & enhancement)

Habitat units

Hedgerow units

Watercourse units

Total net % change

(Including all on-site & off-site habitat retention, creation & enhancement)

Habitat units

Hedgerow units

Watercourse units

Trading rules satisfied?

No - Check Trad

Unit Type	Target	Baseline Units	Units Required
<i>Habitat units</i>	10.00%	0.74	0.82
<i>Hedgerow units</i>	10.00%	0.00	0.00
<i>Watercourse units</i>	10.00%	0.00	0.00

Input errors/rule breaks present in metric ▲

0.74
0.00
0.00

0.44
0.00
0.00

-0.31	-41.47%
0.00	0.00%
0.00	0.00%

On-site net gain is less than target set Δ

0.00
0.00
0.00

0.00
0.00
0.00

0.00	0.00%
------	-------

0.00	0.00%
0.00	0.00%

-0.31
0.00
0.00

0.00
0.00
0.00

--

-0.31
0.00
0.00

-41.47%	Total net gain achieved is less than target set ▲
----------------	--

0.00%
0.00%

ing Summaries ▲

Unit Deficit
0.38
0.00
0.00

No additional hedgerow units required to meet target ✓
No additional watercourse units required to meet target ✓



Project Name

Condensed

Map

Ref	Broad Habitat
1	Urban
2	Grassland
3	Grassland
4	Urban
5	Individual trees
6	
7	
8	
9	
10	
11	
12	
13	
14	
15	
16	
17	
18	
19	
20	
21	
22	
23	
24	
25	
26	

27	
28	
29	
30	
31	
32	
33	
34	
35	
36	
37	
38	
39	
40	
41	
42	
43	
44	
45	
46	
47	
48	
49	
50	
51	
52	
53	
54	
55	
56	
57	
58	
59	
60	
61	
62	
63	
64	
65	
66	
67	
68	
69	
70	
71	
72	
73	
74	

75	
76	
77	
78	
79	
80	
81	
82	
83	
84	
85	
86	
87	
88	
89	
90	
91	
92	
93	
94	
95	
96	
97	
98	
99	
100	
101	
102	
103	
104	
105	
106	
107	
108	
109	
110	
111	
112	
113	
114	
115	
116	
117	
118	
119	
120	
121	
122	

123	
124	
125	
126	
127	
128	
129	
130	
131	
132	
133	
134	
135	
136	
137	
138	
139	
140	
141	
142	
143	
144	
145	
146	
147	
148	
149	
150	
151	
152	
153	
154	
155	
156	
157	
158	
159	
160	
161	
162	
163	
164	
165	
166	
167	
168	
169	
170	

171	
172	
173	
174	
175	
176	
177	
178	
179	
180	
181	
182	
183	
184	
185	
186	
187	
188	
189	
190	
191	
192	
193	
194	
195	
196	
197	
198	
199	
200	
201	
202	
203	
204	
205	
206	
207	
208	
209	
210	
211	
212	
213	
214	
215	
216	
217	
218	

219	
220	
221	
222	
223	
224	
225	
226	
227	
228	
229	
230	
231	
232	
233	
234	
235	
236	
237	
238	
239	
240	
241	
242	
243	
244	
245	
246	
247	
248	





Bespoke compensation agreed for losses of VHDH or irreplaceable habitat	User comments
	N/A
	Passes C, D, E,
	retained grassland along pathway - temporarily impacted-0.028- Passes -C,D,E, F, G- G1 minor temporary impact retained
	N/A
	14 small trees within the Siteall lost- pass, A,(native only and B, D, F



Project N

Condense / St

Main

Ref	Broad Habitat
1	Urban
2	Urban
3	Urban
4	Grassland
5	Individual trees
6	Grassland
7	
8	
9	
10	
11	
12	
13	
14	
15	
16	
17	
18	
19	
20	
21	
22	
23	

24	
25	
26	
27	
28	
29	
30	
31	
32	
33	
34	
35	
36	
37	
38	
39	
40	
41	
42	
43	
44	
45	
46	
47	
48	
49	
50	
51	
52	
53	
54	
55	
56	
57	
58	
59	
60	
61	
62	
63	
64	
65	
66	
67	
68	
69	
70	
71	
72	
73	

74	
75	
76	
77	
78	
79	
80	
81	
82	
83	
84	
85	
86	
87	
88	
89	
90	
91	
92	
93	
94	
95	
96	
97	
98	
99	
100	
101	
102	
103	
104	
105	
106	
107	
108	
109	
110	
111	
112	
113	
114	
115	
116	
117	
118	
119	
120	
121	
122	
123	

124	
125	
126	
127	
128	
129	
130	
131	
132	
133	
134	
135	
136	
137	
138	
139	
140	
141	
142	
143	
144	
145	
146	
147	
148	
149	
150	
151	
152	
153	
154	
155	
156	
157	
158	
159	
160	
161	
162	
163	
164	
165	
166	
167	
168	
169	
170	
171	
172	
173	

174	
175	
176	
177	
178	
179	
180	
181	
182	
183	
184	
185	
186	
187	
188	
189	
190	
191	
192	
193	
194	
195	
196	
197	
198	
199	
200	
201	
202	
203	
204	
205	
206	
207	
208	
209	
210	
211	
212	
213	
214	
215	
216	
217	
218	
219	
220	
221	
222	
223	

224	
225	
226	
227	
228	
229	
230	
231	
232	
233	
234	
235	
236	
237	
238	
239	
240	
241	
242	
243	
244	
245	
246	



0.35

0.30

Select a unit	Hectares	M ²





Post intervention habitats

Standard time to target condition (years)	Habitat created in advance (years)	Delay in starting habitat creation (years)
0	0	2
5	0	1
1	0	2
1	0	2
10	0	2
2	0	2

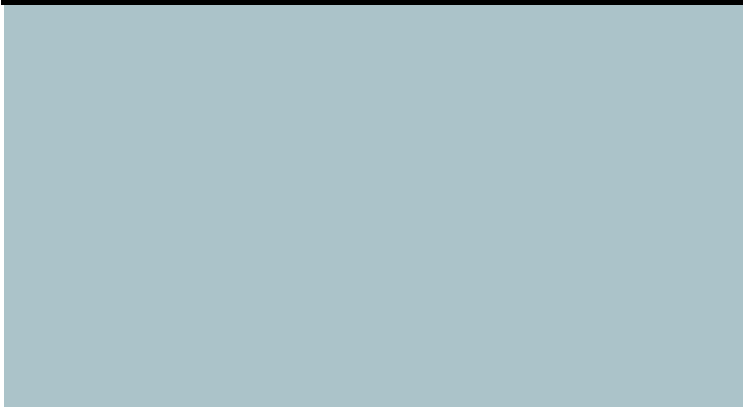



Temporal multiplier

Standard or adjusted time to target condition	Final time to target condition (years)	Final time to target multiplier
Standard time to target condition applied	2	0.931
Check details- Delay in starting habitat in required condition? ⚠	6	0.808
Check details- Delay in starting habitat in required condition? ⚠	3	0.899
Check details- Delay in starting habitat in required condition? ⚠	3	0.899
Check details- Delay in starting habitat in required condition? ⚠	12	0.652
Check details- Delay in starting habitat in required condition? ⚠	4	0.867



Habitat units delivered	User comments
0.00	N/A
0.09	Area without solar panels passes A , B, C and G but no additional habitat provided.. Area with solar panels passess A and C
0.06	N/A
0.02	reinstated grassland-in previous condition-Passes C,D,E, F, G
0.13	12 small trees in poor condition due to being in restricted growth due to locaiton- 9 small trees within the Site - 1 tree retained- pass, A,(native only and B, D, F
0.08	Passes C, D, E,

